



FIBER CEMENT BOARD DRILL SCREWS

Attachment of Fiber Cement boards to steel from 20 ~ 14 gauge steel

Brand Names of Fiber Cement Boards

Hardibacker®
Hardiplank®
Hardipanel®
Rhino Board

MaxiPanel®
MaxiSoffit®
MaxiPlank®
MaxiBacker®

Plycem® underlayment
Induco M & HD
Wince
Duraco

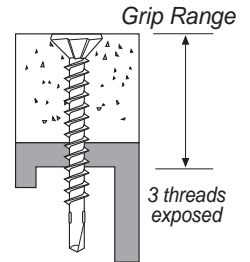

#2 Reduced Phillips

Product Specifications



Flathead with Nibs for a countersink finish.

| Part # | Dia. | Length | TPI | Bulk Qty | Finish | Head | Head Dia. | Grip Range | Drill Capacity |
|---------|------|--------|-----|----------|-----------------|--------------|-----------|------------|----------------|
| FCBD114 | 8 | 1-1/4 | 18 | 5M | PrimeGuard Plus | Flat w/ nibs | 8-8.5 mm | 5/8" | .035"-.100" |
| FCBD158 | 8 | 1-5/8 | 18 | 5M | PrimeGuard Plus | Flat w/ nibs | 8-8.5 mm | 1" | .035"-.100" |
| FCBD214 | 8 | 2-1/4 | 18 | 2.5M | PrimeGuard Plus | Flat w/ nibs | 8-8.5 mm | 1-5/8" | .035"-.100" |

Pro-Twist fiber cement board drill screws meet or exceed ASTM C-1513

| PrimeGuard Plus | | |
|--|-----------------------------------|-----------|
| Corrosion Resistance | Applied Via | Guarantee |
| 1000 hr. min. B-117 12 Cycles Kesternich* | Multi-Step Proprietary Process | Lifetime |

*Kesternich is an acid test protocol meeting DIN 50018, ASTM G-87

| Self-Drilling Screws Ultimate Connection Value Chart | | | | |
|--|-----------------|---------------------------|----------------------|-----------------------|
| Dia. | Metal Gauge/1lb | Tension (Pull) lbs. 1 Pc. | Shear Strength (lbs) | Torque Strength (lbs) |
| 8 | 20 | 285 | 1241 | 45 |
| | 18 | 444 | | |
| | 16 | 502 | | |
| | 14 | 924 | | |
| | 12 | 1100 | | |

Ultimate Value Charts

Screws driven into steel were driven with three exposed threads on the off side of the connection, then pulled out with testing machine.

Note that all results were obtained in strict adherence to ASTM test protocol. These ultimate figures are offered only as a guide and are not guaranteed in any way by PrimeSource Building Products. A 4:1 safety ratio is recommended.

Installation Guidelines

0-2500rpm Screwgun with torque adjustment - Overdriving may result in fastener failure or stripout of the work surface
The fastener is fully seated when the head's bearing surface is flush with the fiber cement material.
The fastener must penetrate beyond the metal a minimum of three threads to comply with the code.

ALL PRIMESOURCE FASTENERS ARE MANUFACTURED IN AN ISO 9002 AND ISO 14001 CERTIFIED AND APPROVED FACTORY TO PRIMESOURCE PERFORMANCE SPECIFICATIONS AND PRINT DRAWINGS.

FIBER CEMENT BOARD SCREWS FOR WOOD



Attachment of Fiber Cement board to wood.

Brand Names of Fiber Cement Boards

Hardibacker®
Hardiplank®
Hardipanel®
Rhino Board

MaxiPanel®
MaxiSoffit®
MaxiPlank®
MaxiBacker®

Plycem® underlayment
Induco M & HD
Wince
Duraco

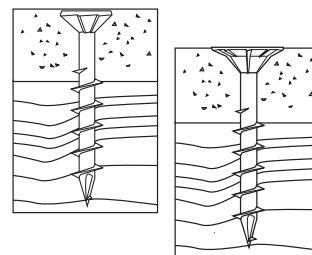

.323" (8.2mm)



#2 Phillips

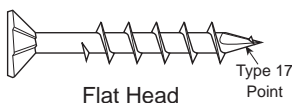

Product Specifications

.400" (10.2mm)

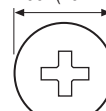

#2 Phillips

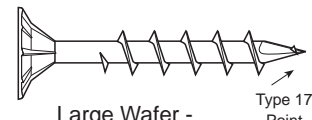

| Part # | Dia. | Length | TPI | Bulk Qty | Finish | Head | Head Dia. | Point |
|-----------|------|--------|-----|----------|-----------------|---------------|-------------|---------------------|
| FCBS114 | 8 | 1-1/4 | 10 | 8M | PrimeGuard Plus | Flat w/ nibs | 8.0-8.5 mm | Sharp 'S' - Type 17 |
| FCBS158 | 8 | 1-5/8 | 10 | 5M | PrimeGuard Plus | Flat w/ nibs | 8.0-8.5 mm | Sharp 'S' - Type 17 |
| FCBSS114* | 8 | 1-1/4 | 10 | 8M | PrimeGuard Plus | Wafer w/ nibs | 9.9-10.5 mm | Sharp 'S' - Type 17 |
| FCBSS158* | 8 | 1-5/8 | 10 | 5M | PrimeGuard Plus | Wafer w/ nibs | 9.9-10.5 mm | Sharp 'S' - Type 17 |

* Large wafer style head for a flush connection in areas of high wind.

Pro-Twist sharp fiber cement board screws meet or exceed ASTM C-1513

| PrimeGuard Plus | | |
|--|-----------------------------------|-----------|
| Corrosion Resistance | Applied Via | Guarantee |
| 1000 hr. min. B-117 12 Cycles Kesternich* | Multi-Step Proprietary Process | Lifetime |

*Kesternich is an acid test protocol meeting DIN 50018, ASTM G-87

| Sharp Point Screws Ultimate Connection Value Chart | | | |
|--|---------------------------|----------------------|-----------------------|
| Dia. | Plywood Tension(Pull) lbs | Shear Strength (lbs) | Torque Strength (lbs) |
| 8 | 362 | 1529 | 45 |

Ultimate Value Charts

Screws driven into 3/4" into wood then pulled out with testing machine.

Note that all results were obtained in strict adherence to ASTM test protocol. These ultimate figures are offered only as a guide and are not guaranteed in any way by PrimeSource Building Products. A 4:1 safety ratio is recommended.

Installation Guidelines

0-2500rpm Screwgun with torque adjustment - Overdriving may result in fastener failure or stripout of the work surface
The fastener is fully seated when the head's bearing surface is flush with the fiber cement material.
The fastener must penetrate beyond the wood a minimum of three threads to comply with the code.

ALL PRIMESOURCE FASTENERS ARE MANUFACTURED IN AN ISO 9002 AND ISO 14001 CERTIFIED AND APPROVED FACTORY TO PRIMESOURCE PERFORMANCE SPECIFICATIONS AND PRINT DRAWINGS.