



FIBER CEMENT BOARD DRILL SCREWS

Attachment of Fiber Cement boards to steel from 20 ~ 14 gauge steel

Brand Names of Fiber Cement Boards

Hardibacker®
Hardiplank®
Hardipanel®
Rhino Board

MaxiPanel®
MaxiSoffit®
MaxiPlank®
MaxiBacker®

Plycem® underlayment
Induco M & HD
Wince
Duraco

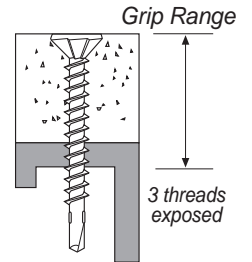

#2 Reduced Phillips

Product Specifications



Flathead with Nibs for a countersink finish.

Part #	Dia.	Length	TPI	Bulk Qty	Finish	Head	Head Dia.	Grip Range	Drill Capacity
FCBD114	8	1-1/4	18	5M	PrimeGuard Plus	Flat w/ nibs	8-8.5 mm	5/8"	.035"-.100"
FCBD158	8	1-5/8	18	5M	PrimeGuard Plus	Flat w/ nibs	8-8.5 mm	1"	.035"-.100"
FCBD214	8	2-1/4	18	2.5M	PrimeGuard Plus	Flat w/ nibs	8-8.5 mm	1-5/8"	.035"-.100"

Pro-Twist fiber cement board drill screws meet or exceed ASTM C-1513

PrimeGuard Plus		
Corrosion Resistance	Applied Via	Guarantee
1000 hr. min. B-117 12 Cycles Kesternich*	Multi-Step Proprietary Process	Lifetime

*Kesternich is an acid test protocol meeting DIN 50018, ASTM G-87

Self-Drilling Screws Ultimate Connection Value Chart				
Dia.	Metal Gauge/1lb	Tension (Pull) lbs. 1 Pc.	Shear Strength (lbs)	Torque Strength (lbs)
8	20	285	1241	45
	18	444		
	16	502		
	14	924		
	12	1100		

Ultimate Value Charts

Screws driven into steel were driven with three exposed threads on the off side of the connection, then pulled out with testing machine.

Note that all results were obtained in strict adherence to ASTM test protocol. These ultimate figures are offered only as a guide and are not guaranteed in any way by PrimeSource Building Products. A 4:1 safety ratio is recommended.

Installation Guidelines

0-2500rpm Screwgun with torque adjustment - Overdriving may result in fastener failure or stripout of the work surface
The fastener is fully seated when the head's bearing surface is flush with the fiber cement material.
The fastener must penetrate beyond the metal a minimum of three threads to comply with the code.

ALL PRIMESOURCE FASTENERS ARE MANUFACTURED IN AN ISO 9002 AND ISO 14001 CERTIFIED AND APPROVED FACTORY TO PRIMESOURCE PERFORMANCE SPECIFICATIONS AND PRINT DRAWINGS.

FIBER CEMENT BOARD SCREWS FOR WOOD



Attachment of Fiber Cement board to wood.

Brand Names of Fiber Cement Boards

Hardibacker®
Hardiplank®
Hardipanel®
Rhino Board

MaxiPanel®
MaxiSoffit®
MaxiPlank®
MaxiBacker®

Plycem® underlayment
Induco M & HD
Wince
Duraco

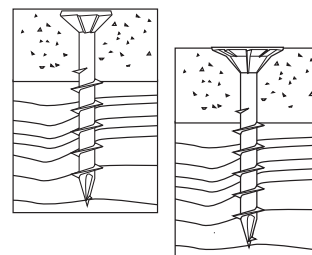

.323" (8.2mm)



#2 Phillips

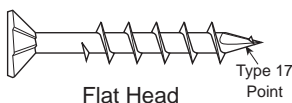

Product Specifications

.400" (10.2mm)

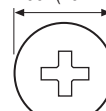

#2 Phillips



Part #	Dia.	Length	TPI	Bulk Qty	Finish	Head	Head Dia.	Point
FCBS114	8	1-1/4	10	8M	PrimeGuard Plus	Flat w/ nibs	8.0-8.5 mm	Sharp 'S' - Type 17
FCBS158	8	1-5/8	10	5M	PrimeGuard Plus	Flat w/ nibs	8.0-8.5 mm	Sharp 'S' - Type 17
FCBSS114*	8	1-1/4	10	8M	PrimeGuard Plus	Wafer w/ nibs	9.9-10.5 mm	Sharp 'S' - Type 17
FCBSS158*	8	1-5/8	10	5M	PrimeGuard Plus	Wafer w/ nibs	9.9-10.5 mm	Sharp 'S' - Type 17

* Large wafer style head for a flush connection in areas of high wind.

Pro-Twist sharp fiber cement board screws meet or exceed ASTM C-1513

PrimeGuard Plus		
Corrosion Resistance	Applied Via	Guarantee
1000 hr. min. B-117 12 Cycles Kesternich*	Multi-Step Proprietary Process	Lifetime

*Kesternich is an acid test protocol meeting DIN 50018, ASTM G-87

Sharp Point Screws Ultimate Connection Value Chart			
Dia.	Plywood Tension(Pull) lbs	Shear Strength (lbs)	Torque Strength (lbs)
8	362	1529	45

Ultimate Value Charts

Screws driven into 3/4" into wood then pulled out with testing machine.

Note that all results were obtained in strict adherence to ASTM test protocol. These ultimate figures are offered only as a guide and are not guaranteed in any way by PrimeSource Building Products. A 4:1 safety ratio is recommended.

Installation Guidelines

0-2500rpm Screwgun with torque adjustment - Overdriving may result in fastener failure or stripout of the work surface
The fastener is fully seated when the head's bearing surface is flush with the fiber cement material.
The fastener must penetrate beyond the wood a minimum of three threads to comply with the code.

ALL PRIMESOURCE FASTENERS ARE MANUFACTURED IN AN ISO 9002 AND ISO 14001 CERTIFIED AND APPROVED FACTORY TO PRIMESOURCE PERFORMANCE SPECIFICATIONS AND PRINT DRAWINGS.